



MURRAY RIVER  
PADDLESTEAMERS  
ECHUCA

# Fall in love with **PS EMMYLOU**

Authentic Australian River Cruises



2021  
Travelers'  
Choice



ECHUCA VICTORIA AUSTRALIA  
SEASON 2023/24



# Your Authentic Australian River Cruise

Cruise along the majestic Murray River at an ambling speed aboard the world's only accommodated wood-fire paddle steamer.

The Murray River, also known as 'the Mighty Murray,' is a magnificent natural wonder that stretches over 2,000 kilometres from Kosciusko National Park in New South Wales, through Victoria, and all the way to Goolwa, South Australia. Its impressive size and beauty have earned it its fitting nickname, as it is the world's third-longest navigable river, surpassed only by the Nile and the Amazon.

For over 40,000 years, Aboriginal communities have lived alongside the river and have left their mark on the landscape. Evidence of their habitation, dating back thousands of years, can still be seen today. The river continues to play an essential role in the agricultural industry for much of inland Victoria and serves as a significant water supply for over 1.5 million households.

The Murray River offers a unique destination to explore one of Australia's most beautiful regions. Visitors can enjoy exploring the riverside towns, discovering the local wildlife, and, of course, taking a relaxing cruise on an old paddlesteamer. One such paddle steamer, the Emmylou, has become a popular and iconic choice for thousands of visitors looking to experience the river in a unique and luxurious way.

Emmylou is the world's only accommodated wood-fire paddle steamer and has been masterfully restored to blend the old with the new. This authentic luxury cruise seamlessly immerses passengers in a bygone era while still providing modern-day comforts. The ship offers three, four, or a combined 7-night cruise,

all-inclusive experiences that allow guests to enjoy the journey as much as the destination.

As passengers board the Emmylou, they are welcomed by the warmth of the 1906 steam engine, and they can watch as the engineer stokes the boiler. Guests can even climb into the wheelhouse to chat with the skipper or sit back and enjoy the changing reflections in the water. The journey offers something for everyone, whether you're captivated by the river itself, the region's pioneering history, or just looking for a way to unwind and relax, the Emmylou provides the ultimate antidote to stress - a soothing, soul-calming river journey with non-stop pampering from friendly crew members, mouth-watering cuisine, and mesmerising scenery. You will experience the peace, tranquillity and relaxation this unique and very Australian experience offers, and just like many before,

***you will fall in love with Emmylou*** as she unhurriedly saunters down the river.

Despite its small size, the Emmylou has many nooks and crannies where guests can pull up a chair and take in the breathtaking views. The only crowds you'll experience are the flocks of Australian White Ibis feeding in the marshes, Kingfishers hunting for a meal, and mobs of kangaroos.

The Emmylou offers an unforgettable and truly unique way to explore the magnificent Murray River and the surrounding region.





# Contents

YOUR COMPREHENSIVE INCLUSIONS	2
PS EMMYLOU HISTORY	3
LUXURY CABINS	4
REGIONALLY-INSPIRED DINING	5
EXTEND YOUR STAY	6
3 NIGHT DISCOVERY CRUISE	7
4 NIGHT EXPLORER CRUISE	8
7 NIGHT ALL THE RIVERS RUN CRUISE	9
2023-2024 CRUISE DEPARTURES	11
48 HOURS IN ECHUCA MOAMA	12
DRIVING TOURS	13
ECHUCA MOAMA SILO ART TRAIL	15
TERMS & CONDITIONS	17





# Your Comprehensive Inclusions

Return V/Line Train from Melbourne to Echuca

Return Echuca Station Transfers

Return PS Emmylou Coach Transfers

All Meals Including Onshore Tours

Morning and Afternoon Tea

Selected Wines & Beer with dinner service

Complimentary Barista Coffee, Fine Teas,  
Soft Drink and Water

Premium Onshore Guide Tours

Award winning service

Riverside Dining & Campfires with entertainment

Complimentary Wi-Fi

All onboard Gratuities

Book With  
\$400  
Per Person





# PS Emmylou History

PS Emmylou, one of Australia's most iconic Paddlesteamers, cruises the Murray River from Echuca, just a 2.5-hour drive from Melbourne. Named after the renowned American country singer Emmylou Harris, this vessel has been a host to thousands of people, including her namesake, delighting them with unforgettable experiences. PS Emmylou also starred in the popular TV series *All the Rivers Run*, where she was renamed the PS Providence.

What makes Emmylou special is her beautifully restored 1906 Marshall and Sons steam engine, which makes her the only wood fired Paddlesteamer in the world offering regular scheduled accommodated river cruises. The side-wheel Paddlesteamers are distinctly Australian, having first plied the Murray River in 1853, establishing a thriving industry that lasted until the rail and roads began servicing the region at the turn of the century. By 1873, there were 240 boats trading along the Murray River, bringing prosperity and development to the region and keeping the previously out-of-the-way settlements in touch with the cities. With the introduction of the railway, the paddlesteamers and their crews gradually lost work until the riverboat industry became but a shadow of its illustrious past.

However, PS Emmylou reminds us of the romantic days of the paddlesteamers and is now an Australian icon of the river. Built locally during 1980-82 in the style of 19th-century paddlesteamers, she is perfectly at home at the Port of Echuca, residing with the last few remaining paddlesteamers of the past. This 30-meter-long and 10-meter-wide steel-hulled vessel with a timber deck underwent a luxury upgrade and fit-out in 2018. The new contemporary cabins and ensuites feature fine linens topped with silky duvets, with the boat's premier cabin, the Emmylou Suite, located on the front Upper Deck, with French Doors opening to a deck and 180-degree views of the river. The vessel accommodates just 16 guests in 8 deluxe cabins, offering small boat boutique cruising at its finest.

Locally owned and operated for over 25 years, the business continues to grow and expand on strong foundations. We are proud to continue the tradition of overnight cruising on Australia's greatest waterway, providing our trademark level of country hospitality aboard an authentic paddlesteamer. Join us for a unique opportunity to connect with Australia's inland history, geography, culture, and cuisine.



OPTIONAL  
PRE/POST  
HOTEL STAYS



WINE & BEER  
WITH DINNER



ONSHORE TOURS



FREE INTERNET



DELICIOUS  
REGIONAL CUISINE



COFFEE, TEA  
& SNACKS

CONNECT WITH US



@MURRAYRIVERPADDLETEAMERS



@MURRAYRIVERPS



@MURRAYRIVERPS



MURRAYPADDLETEAMERS

# Luxury Cabins

## WELCOME ABOARD

Relax and enjoy the calm water and tranquil surrounds from your private room on the river.

PS Emmylou features eight contemporary luxury cabins, complete with private ensuites, plush bedding and fine linens. Each cabin has individually controlled air-conditioning and windows that bring in the fresh country air and cabin doors that open directly onto the outside deck or veranda. Complimentary WIFI is also available throughout the boat, including in the cabins.

Please note: complimentary coffee and tea making facilities are available in the Saloon throughout your cruise; there are no fridges or coffee/tea making facilities in cabins.

### EMMYLOU QUEEN SUITE

The Emmylou Queen Suite is the boat's premier suite and the most spacious. Located on the upper deck, this elegant suite features plush queen bedding, an ensuite and a seating area. French doors open directly onto the veranda, where you can relax with a drink in hand and take in the ambience as you cruise the Murray River. (12 sqm)

### UPPER DECK QUEEN CABIN

The Upper Deck Queen Cabins allow the outside in, with large doors opening directly onto the veranda. A plush queen bed, with private ensuite makes this a perfect haven to retire to in the evenings. (6.5 sqm)

### UPPER DECK DOUBLE CABIN

The Upper Deck Double Cabin offers a private and comfy sanctuary. Each cabin has a snug double bed, private ensuite and a door opening directly onto the deck. (6.0 sqm)

### UPPER DECK TWIN CABIN

The Upper Deck Twin Cabin offers two full-size single beds, the top bed easily accessible, a private ensuite, and with a door that opens directly onto the deck, so you're sure to get an abundance of natural light. (6.0 sqm)

### MAIN DECK QUEEN CABIN

This private cabin boasts a plush queen bed and private ensuite. The cabin is conveniently located on the main deck with close proximity to the saloon. (6.5 sqm)

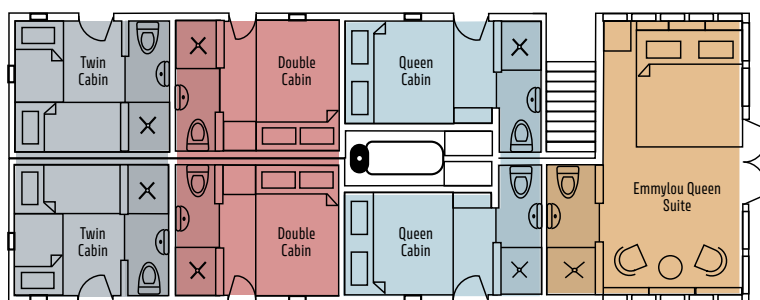
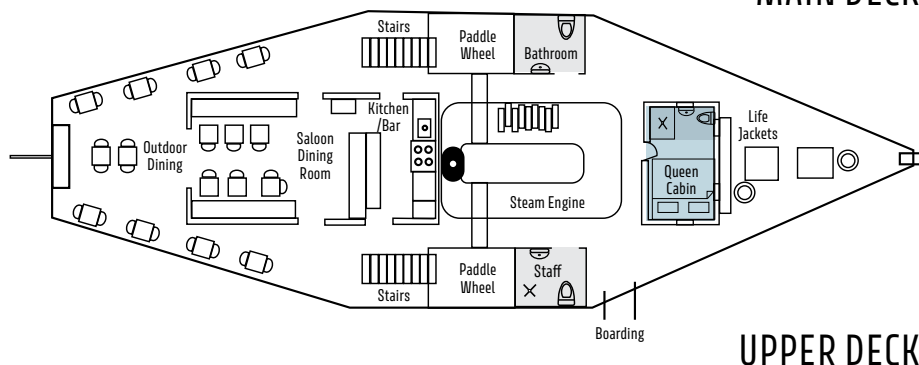

Twin Cabin



Double Cabin



Queen Cabin



Emmylou Queen Suite

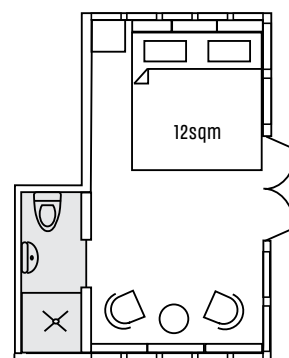
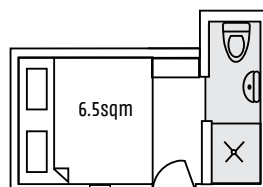
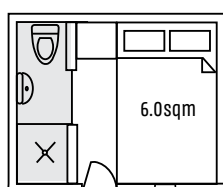
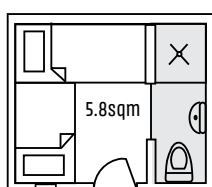





## Regionally-Inspired Dining

Inspired by Australia's heartland, our onboard chef takes full advantage of our region's diverse produce to create hearty meals, but with a contemporary flair.

You'll start your day with a range of continental choices, including delicious pastries, cereals and fresh fruit or a traditional full English breakfast – the choice is yours. With our chef arranging morning tea, lunch and afternoon tea, your focus can remain on the day's activities, rather than on an empty stomach. Depending upon the cruising itinerary and any onshore tours, these meals may be hot lunches or gourmet picnics on the riverbank. In the evenings, our chef prepares multi course dinners.

And, what trip to the Murray is complete without a classic Australian BBQ under the southern stars? Watching the sunset from the banks of the Murray is an extraordinary experience. This time of day really amplifies the sounds of the Murray, as the birds prepare to nest for the evening and they flock overhead.

On all our cruises, you'll be invited to pull up a picnic rug and indulge in this Australian tradition, complete with toasting marshmallows for supper!

We deliberately don't allocate meal seating while onboard the Emmylou. You are free to sit with fellow passengers and swap stories over a meal or enjoy a quiet dinner with your partner on the deck. The choice is yours.

A wide variety of drinks, including wine, beer, aperitifs and soft drinks, are available from the bar. We are proud to support our local wineries.

### DINING ABOARD EMMYLOU

- Tantalising multi course dinners
- Bountiful continental and full breakfast options
- Traditional morning and afternoon teas
- Vegetarian and gluten-free menu options
- Fabulous choice of local and Australian wines and beverages
- Complimentary selected wine & beer with Dinner service
- Free seat dining
- Seasonal alfresco dining with idyllic river views
- Riverside BBQ dining under the stars on all cruises with live entertainment



# Extend Your Stay



## Hotels

Echuca Moama is a destination in its own right and truly worth exploring. Staying a day or two before boarding your cruise, or after you return to dock, is a great way to immerse yourself in regional Australia. We're delighted to partner with an award-winning hotel in Echuca conveniently located close to the port and several Melbourne hotels for those travelling further afield. Pre and post-cruise accommodation can be booked directly through Murray River Paddle Steamers.

### Echuca Undercover Car Parking

Secure undercover warehouse parking is available for cruise passengers' cars and small caravans at a rate of \$25 per day. Prior reservation is required. Please contact us if you have a larger vehicle/caravan.



### Mercure Port of Echuca Hotel

#### *Superior King Room* \$200 per night

Extend your experience in Echuca with a pre or post-cruise stay at the Mercure Port of Echuca Hotel. Located in the centre of town, within walking distance to the port and High Street shops, our exclusive rate offers you a Deluxe Room featuring a king bed, plasma TV and DVD player, exquisite bathroom, pay-TV and wireless internet access.





# 3 NIGHT DISCOVERY CRUISE

## Optional Rail

Start your river cruise from Melbourne – Complimentary. Return V/Line Train fares are included in your cruise fare.

## Optional Echuca Car Parking.

Secure undercover car parking is \$25 per night.

## Check In Location

Echuca Car Park – 3.00pm.

## Departure & Arrival Times

Cruises depart every Friday 4.00pm from Echuca. Disembarking Monday, 9.30am at Torrumbarry.

## Highlights

- Join us for an unforgettable onshore tour that includes a visit to the Great Aussie Beer Shed & Heritage Farm Museum.
- Embark on an expedition eco-cruise aboard the Murray Explorer and enjoy a scenic lunch on the riverbanks.
- Indulge in tastings of the table and fortified wines at Morrisons Riverside Winery.
- Explore Perricoota Station's gardens and marvel at the beauty of the filming location for the famous Australian television series, All the Rivers Run.
- End your day with a memorable riverside BBQ dining experience under the stars, with live entertainment and a crackling campfire.
- Take in the beauty of the Torrumbarry Weir and its surroundings.
- Experience all-day cruising with a historical commentary that will transport you back in time and immerse you in the rich cultural heritage of the Murray River region.

## Inclusions

- Complimentary return V/Line train fare from Melbourne
- Complimentary Echuca coach transfers to/from Emmylou
- Luxury air-conditioned cabin with private ensuite
- All onboard meals including morning and afternoon tea
- Regionally-inspired meals prepared by onboard chef
- Onshore Tours
- Complimentary selected wine & beer with dinner service
- Espresso coffee, tea, soft drink & bottled water
- Complimentary WIFI throughout the boat

## CRUISE PRICES VALID UNTIL 31/03/24

CABIN TYPE	PP TWIN SHARE	SOLO TRAVELER
Main Queen	\$1,740	NA
Upper Twin	\$1,690	\$2,704
Upper Double	\$1,690	NA
Upper Queen	\$1,740	NA
Queen Suite	\$2,100	NA

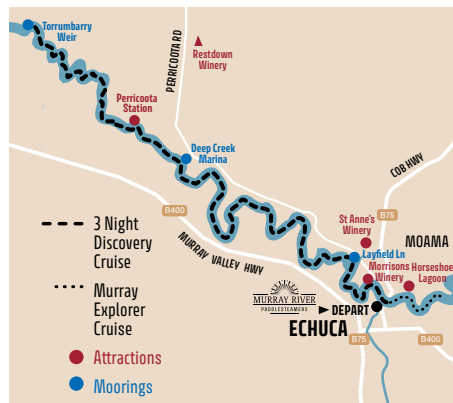

## Day 1. Layfield Lane

As Emmylou departs from Echuca, you can relax and enjoy an afternoon Devonshire tea while taking in the stunning sights and sounds of the river. You will have plenty of time to chat with the skipper and learn about the history of the vessel or simply unwind in your private cabin.

As the sun begins to set, Happy Hour starts, where you can enjoy a drink in the saloon before arriving at Layfield Lane for a grand dinner on the riverbank. The signature Australian BBQ, lit by candles and stars, sets the perfect mood for an evening of casual conversation and live entertainment around the campfire.

## Day 2. Deep Creek Marina

After a satisfying breakfast, you will embark on a half-day land and river tour, visiting the Great Aussie Beer Shed & Heritage Farm Museum. This unique attraction is a celebration of Australia's love of beer and features an extensive collection of over 17,000 cans and bottles from around the world.

You'll then experience the magic of the Murray River on our Eco Expedition boat, the Murray Explorer. After enjoying morning tea at the historic Echuca Wharf, you'll embark on a journey upriver, immersing yourself in the natural wonders of the Murray River.

As you cruise, you'll witness breathtaking scenery and diverse wildlife, all while learning about the rich history of the river from pre-European to early colonial riverboat days. Afterward, we'll make a stop at a remote sandy river beach where you'll enjoy a delicious lunch, surrounded by the beauty of this iconic Australian destination.

Later, you will visit Morrisons Riverside Winery for a quick tasting of their fabulous table and fortified wines before returning to Emmylou for an afternoon tea service as you continue downriver towards Deep Creek Marina. In the evening, you can unwind with a fascinating documentary featuring archival footage of the paddlesteamers and communities of the Murray River.

## Day 3. Torrumbarry Weir

Today Emmylou departs early in the morning for a full day of cruising towards Torrumbarry Weir with a mid-morning stop at the famous Perricoota Station. Join the skipper for a walking tour of the historic buildings and immaculate gardens of Perricoota Station before continuing towards Torrumbarry Weir.

Upon arrival, you can take a guided walk across the weir, visit the Interpretive Centre and learn about the Murray Darling Basin and the weir and lock system that dates back to 1923.

Tonight, enjoy a delicious final dinner hosted by your Skipper with pre-dinner canapes and drinks as the sun settles over the weir. Listen to the river birds' evening chorus and watch for kangaroos, wombats, and various bird species as the stars begin to appear during dinner.

## Day 4. Echuca

This morning, early risers can enjoy a riverside stroll before breakfast. A courtesy vehicle will then be ready to return you to Echuca, where you will reluctantly say farewell to your unforgettable river journey on the PS Emmylou.





# 4 NIGHT EXPLORER CRUISE

## Optional Rail

Start your river cruise from Melbourne – Complimentary. Return V/Line Train fares are included in your cruise fare.

## Optional Echuca Car Parking.

Secure undercover car parking is \$25 per night.

## Check In Location

Echuca Car Park – 3.00pm.

## Departure & Arrival Times

Cruises depart every Monday, 4.00pm from Torrumbarry. Disembarking Friday, 9.30am at Echuca.

## Highlights

- Enjoy an owner-led guided tour of Restdown Winery & wetlands, followed by a delicious lunch.
- Take a town tour of historical Echuca sites and learn about the rich local history.
- Embark on an expedition eco-cruise aboard the Murray Explorer and enjoy a scenic lunch on the riverbanks.
- Indulge in tastings of table and fortified wines at St Anne's Winery.
- Explore the beautiful gardens of Perricoota Station, the famous filming location for All the Rivers Run.
- End your day with a memorable riverside BBQ dining experience under the stars, complete with live entertainment and a crackling campfire.
- Take in the stunning beauty of the Torrumbarry Weir and its surroundings.
- Experience all-day cruising with a historical commentary that will transport you back in time and immerse you in the rich cultural heritage of the Murray River region.

## Inclusions

- Complimentary return V/Line train fare from Melbourne
- Complimentary Echuca coach transfers to/from Emmylou
- Luxury air-conditioned cabin with private ensuite
- All onboard meals including morning and afternoon tea
- Onshore Tours
- Regionally-inspired meals prepared by onboard chef
- Complimentary selected wine & beer with dinner service
- Espresso coffee, tea, soft drink & bottled water
- Complimentary WIFI throughout the boat

## CRUISE PRICES VALID UNTIL 31/03/24

CABIN TYPE	PP TWIN SHARE	SOLO TRAVELER
Main Queen	\$2,360	NA
Upper Twin	\$2,300	\$3,680
Upper Double	\$2,300	NA
Upper Queen	\$2,360	NA
Queen Suite	\$2,840	NA

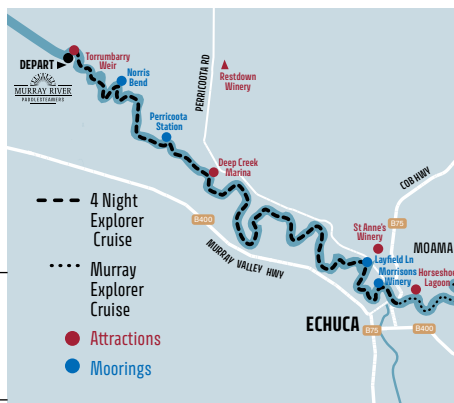

## Day 1. Norris Bend

As Emmylou departs Torrumbarry upstream, take the opportunity to savour an afternoon Devonshire tea while enjoying the picturesque views and acquainting yourself with fellow cruisers.

You may chat with the skipper in the wheelhouse to learn about PS Emmylou's river history, relax in your private cabin or relish a drink in the saloon during "Happy Hour" as the sun sets.

In the evening, the crew will have a riverside campfire ready for you to enjoy after a chef-prepared welcome dinner at Norris Bend. Keep an eye out for kangaroos, wombats, and birds as you bask in the river birds' evening chorus and the emerging stars.

## Day 2. Perricoota Station

After a hearty breakfast, PS Emmylou will cruise to the famous Perricoota Station. You'll have the opportunity to board of coach to visit Restdown Winery joining the property's owners for a guided tour along a 1.4km wetlands walking trail, highlighting items of Aboriginal significance before enjoying a gourmet lunch of local produce and wine tastings.

Afterward, you'll walk along the historic buildings and immaculate gardens of Perricoota Station before enjoying a fabulous dinner on Emmylou's deck overlooking the famous property and river.

The night will conclude with a fascinating documentary featuring archival footage of the paddlesteamers and communities of the Murray River.



## Day 3. Layfield Lane

For early risers and avid photographers, the morning mist and wildlife around Perricoota is a spectacle to behold. Enjoy a full day of cruising upstream towards Layfield Lane with lunch on the deck or in the saloon.

Afterward, experience a grand dinner on the riverbank with our signature Australian BBQ, followed by live entertainment and casual conversation around the campfire (weather dependent).

## Day 4. Moama Wharf

Begin your day with a rewarding breakfast before embarking on a half-day land and river tour. Your tour explores the historic town of Echuca discovering little-known historic sites such as Hopwood's Punt and pontoon bridge, which was the first crossing of the river created by Echuca's founder Henry Hopwood.

You'll then experience the magic of the Murray River on our Eco Expedition boat, the Murray Explorer. After enjoying morning tea at the historic Echuca Wharf, you'll embark on a journey upriver, immersing yourself in the natural wonders of the Murray River.

As you cruise, you'll witness breathtaking scenery and diverse wildlife, all while learning about the rich history of the river from pre-European to early colonial riverboat days. Afterward, we'll make a stop at a remote sandy river beach where you'll enjoy a delicious lunch, surrounded by the beauty of this iconic Australian destination.

We then visit St Anne's winery, Perricoota region's largest winery for a quick tasting of their fabulous table and fortified wines before returning to Emmylou for an afternoon tea service as you continue upriver towards mooring overnight at Moama Wharf.

## Day 5. Echuca

Before breakfast, early risers can enjoy a wander along the boardwalks of Horseshoe Lagoon, indulging in some wildlife spotting and learning about the importance of wetlands and floodplains along the mighty Murray River before PS Emmylou departs for the Port of Echuca, where we reluctantly say farewell.





# 7 NIGHT ALL THE RIVERS RUN CRUISE

## Optional Rail

Start your river cruise from Melbourne – Complimentary. Return V/Line Train fares are included in your cruise fare.

## Optional Echuca Car Parking.

Secure undercover car parking is \$25 per night.

## Check In Location

Echuca Car Park – 3.00pm.

## Departure & Arrival Times

Cruises depart every Monday, 4.00pm from Torrumbarry. Disembarking Following Monday, 9.30am at Torrumbarry.

## Highlights

- Guided gardens tour of Perricoota Station
- Riverside BBQ Dining under the stars, campfires & Live Entertainment (riverside dinner is seasonal)
- Lagoon Wetlands Eco walk
- Goulburn & Campaspe expedition river cruise
- Owner led Guided tour of Restdown Winery & wetlands with lunch
- Silo Arts Tour with lunch at Colbinabbin Pub
- Guided walking tour of the historical Port of Echuca
- Visit St Anne's Winery to sample their fabulous table and fortified wines
- Ample time to absorb the gorgeous surroundings and watch and listen to the local Australian wildlife
- All-day cruising with historical commentary

## Inclusions

- Luxury air-conditioned cabin with private ensuite
- All meals including morning and afternoon tea
- Chef prepared Regionally-inspired meals
- Onshore Tours
- Selected wine & beer with dinner service
- Espresso coffee, tea, soft drink & bottled water
- WIFI throughout the boat
- Complimentary return transfers to Torrumbarry Weir from Echuca and Car Parking

## CRUISE PRICES VALID UNTIL 31/03/24

CABIN TYPE	PP TWIN SHARE	SOLO TRAVELER
Main Queen	\$4,080	NA
Upper Twin	\$3,980	\$6,368
Upper Double	\$3,980	NA
Upper Queen	\$4,080	NA
Queen Suite	\$4,880	NA

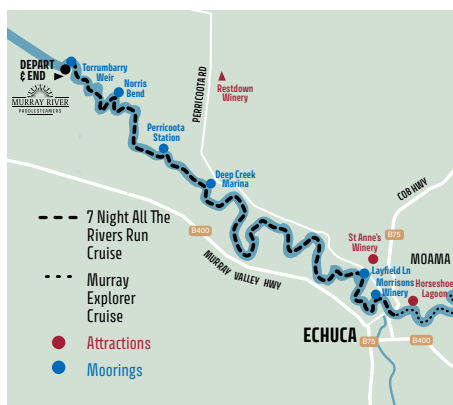

## Day 1. Norris Bend

As Emmylou departs Torrumbarry and have the opportunity to indulge in an afternoon Devonshire tea while taking in the scenic views and getting to know your fellow cruisers. You can chat with the skipper in the wheelhouse and learn about the river history of PS Emmylou or unwind in your private cabin or the saloon during "Happy Hour" as the sun sets.

In the evening, the crew will set up a riverside campfire for you to enjoy after a welcome dinner at Norris Bend, prepared by the chef. You can also look out for kangaroos, wombats, and birds while taking in the evening chorus of the river birds and the emerging stars.

## Day 2. Perricoota Station

After a hearty breakfast before cruising to the famous Perricoota Station. You'll have the chance to board our coach for a visit to Restdown winery with the property's owners, walk along a 1.4km wetlands trail with significant Aboriginal items, and enjoy a gourmet lunch of local produce and wine tastings.

You can then explore the historical buildings and immaculate gardens of Perricoota Station before having dinner on Emmylou's deck overlooking the mansion.

The night will conclude with a fascinating documentary featuring archival footage of the paddlesteamers and communities of the Murray River.



## Day 3. Layfield Lane

For early risers and avid photographers, the morning mist and wildlife around Perricoota is a spectacle to behold. You'll then spend the whole day cruising upstream towards Layfield Lane, enjoying lunch on the deck or in the saloon.

In the evening, you can experience a grand dinner on the riverbank with the signature Australian BBQ, followed by live entertainment and casual conversation around the campfire (weather dependent).







#### Day 4. Moama Wharf

Begin your day with a satisfying breakfast before embarking on a half-day land and river tour. Your tour explores the historical town of Echuca discovering little-known historical sites such as Hopwood's Punt and pontoon bridge, which was the first crossing of the river created by Echuca's founder Henry Hopwood.

You'll then experience the magic of the Murray River on our Eco Expedition boat, the Murray Explorer. After enjoying morning tea at the historic Echuca Wharf, you'll embark on a journey upriver, immersing yourself in the natural wonders of the Murray River.

As you cruise, you'll witness breathtaking scenery and diverse wildlife, all while learning about the rich history of the river from pre-European to early colonial riverboat days. Afterward, we'll make a stop at a remote sandy river beach where you'll enjoy a delicious lunch, surrounded by the beauty of this iconic Australian destination.

We then visit St Anne's winery, Perricoota region's largest winery for a quick tasting of their fabulous table and fortified wines before returning to Emmylou for an afternoon tea service as you continue upriver towards mooring overnight at Moama Wharf.

#### Day 5. Echuca & Layfield Lane

This morning Emmylou cruises into the Port of Echuca, which was first built in the 1860s to support the booming river trade and was once the largest inland port in Australia.

You'll enjoy a half-day tour visiting two spectacular local art silos at Rochester and Colbinabbin, stopping for lunch at the local pub before visiting the fabulous Kyabram water tank. Returning to Echuca, explore the historical port precinct on a guided walking tour and visit the High Street shops and cafes.

Back aboard Emmylou, you can enjoy an afternoon Devonshire tea while cruising downstream. Happy Hour starts as the sun sets, where you can enjoy a drink in the saloon before arriving at Layfield Lane for a grand dinner on the riverbank with the signature Australian BBQ.

#### Day 6. Deep Creek Marina

After a rewarding breakfast, you will embark on a half-day land and river tour that includes a visit to the Great Aussie Beer Shed & Heritage Farm Museum. This unique attraction celebrates Australia's love for beer and boasts a vast collection of over 17,000 cans and bottles from all over the world.

It's then time for an unforgettable Eco Expedition on the Murray Explorer, where you'll discover the enchanting beauty of the Murray River. We begin with a delightful morning tea at the historic Echuca Wharf before setting off upriver.

As you cruise, you'll witness breathtaking scenery and diverse wildlife, all while learning about the rich history of the river from pre-European to early colonial riverboat days. After a thrilling journey, we'll make a stop at a remote sandy river beach where you'll savor a delicious lunch amidst the stunning natural surroundings of this iconic Australian destination.

On your return to Emmylou we visit Morrisons riverside winery for a quick tasting of their fabulous table and fortified wines before returning to Emmylou for an afternoon tea service as you continue downriver towards Deep Creek Marina.

#### Day 7. Torrumbarry Weir

PS Emmylou departs early for a full day of cruising with a stop at the famous Perricoota Station before continuing downriver towards Torrumbarry Weir. Upon arrival, you can take a guided walk across the weir with the Skipper, visiting the Interpretive Centre and learning about the Murray Darling Basin, the weir, and the lock system that dates back to 1923. Tonight, enjoy a delicious final dinner hosted by your Skipper with pre-dinner canapes and drinks as the sun settles over the weir. Listen to the river birds' evening chorus and watch for kangaroos, wombats, and various bird species as the stars begin to appear during dinner.

#### Day 8. Echuca

Early risers can enjoy a riverside stroll before breakfast. A courtesy vehicle will then be ready to return you to Echuca, where you will reluctantly say farewell to your unforgettable river journey on the PS Emmylou.





# 2023-2024 Cruise Departures

CRUISE DATES MAY BE SUBJECT TO CHANGE. SUBJECT TO AVAILABILITY.

## APRIL 2023

M	T	W	T	F	S	S
					1	2
3	4	5	6	7	8	9
10	11	12	13	14	15	16
17	18	19	20	21	22	23
24	25	26	27	28	29	30

## MAY 2023

M	T	W	T	F	S	S
1	2	3	4	5	6	7
8	9	10	11	12	13	14
15	16	17	18	19	20	21
22	23	24	25	26	27	28
29	30	31				

## JUNE 2023

M	T	W	T	F	S	S
			1	2	3	4
5	6	7	8	9	10	11
12	13	14	15	16	17	18
19	20	21	22	23	24	25
26	27	28	29	30		

## JULY 2023

M	T	W	T	F	S	S
31					1	2
3	4	5	6	7	8	9
10	11	12	13	14	15	16
17	18	19	20	21	22	23
24	25	26	27	28	29	30

## AUGUST 2023

M	T	W	T	F	S	S
	1	2	3	4	5	6
7	8	9	10	11	12	13
14	15	16	17	18	19	20
21	22	23	24	25	26	27
28	29	30	31			

## SEPTEMBER 2023

M	T	W	T	F	S	S
				1	2	3
4	5	6	7	8	9	10
11	12	13	14	15	16	17
18	19	20	21	22	23	24
25	26	27	28	29	30	

## OCTOBER 2023

M	T	W	T	F	S	S
30	31					1
2	3	4	5	6	7	8
9	10	11	12	13	14	15
16	17	18	19	20	21	22
23	24	25	26	27	28	29

## NOVEMBER 2023

M	T	W	T	F	S	S
		1	2	3	4	5
6	7	8	9	10	11	12
13	14	15	16	17	18	19
20	21	22	23	24	25	26
27	28	29	30			

## DECEMBER 2023

M	T	W	T	F	S	S
				1	2	3
4	5	6	7	8	9	10
11	12	13	14	15	16	17
18	19	20	21	22	23	24
25	26	27	28	29	30	31

## JANUARY 2024

M	T	W	T	F	S	S
1	2	3	4	5	6	7
8	9	10	11	12	13	14
15	16	17	18	19	20	21
22	23	24	25	26	27	28
29	30	31				

## FEBRUARY 2024

M	T	W	T	F	S	S
			1	2	3	4
5	6	7	8	9	10	11
12	13	14	15	16	17	18
19	20	21	22	23	24	25
26	27	28	29			

## MARCH 2024

M	T	W	T	F	S	S
				1	2	3
4	5	6	7	8	9	10
11	12	13	14	15	16	17
18	19	20	21	22	23	24
25	26	27	28	29	30	31

3 NIGHT ONE WAY FROM ECHUCA TO TORRUMBARRY WEIR

4 NIGHT ONE WAY FROM TORRUMBARRY WEIR TO ECHUCA

7 NIGHT RETURN CRUISE – DEPARTS MONDAY'S FROM TORRUMBARRY WEIR







# 48 Hours in Echuca Moama

Arriving at the twin towns of Echuca Moama nestled on Australia's longest navigable river, replete with Mediterranean climate, you'll be able to boast about visiting two Australian states (NSW & Victoria) in one day.

48 hours in Echuca Moama provides a suggested highlights itinerary to make the most of your stay.



## DAY 1

### 9AM BREAKFAST

Indulge in one of the many coffee spots around town – enjoy breakfast at one of the quaint sidewalk cafes

### 10AM MID MORNING

Step into the historic Port precinct, wander through the heritage streetscape, taking in the artists at work, the galleries, the winery, fudge shop, blacksmith at work & hop aboard the horse and carriage for a short ride around the town. Browse the displays telling stories of the river trade at the Port of Echuca Discovery Centre & the historic wharf.

### 11AM WHARF TO WINERY

Indulge in Australia's most unique restaurant aboard one of the Australia's historic Paddlesteamers, while cruising the river.

Take the Wharf to Winery cruise, enjoying lunch at Morrisons Winery overlooking the vineyards & river.

### 2.30PM EARLY AFTERNOON

Having spent a leisurely few hours dining on or near the river, ramp it up with a visit to the strawberry farm (October – May) to pick your own strawberries and have a mid afternoon strawberry ice cream – breathe in the strawberry aroma while the luscious red berries are succulently warm and ready for tasting.

### 4PM LATE AFTERNOON

Call into the great Aussie Beer Shed on the way home to Echuca and marvel at the Australiana collection and unlock the stories of many facets of Australian life. Back in town refresh at your accommodation and take a walk along the banks of the river through the stands of river red gums. Enjoy dusk with the setting sun as the birds fly in and sing their evening songs.

### 8PM DINNER

Dine at one of Echuca Moama's signature restaurants – the choice is yours! Local produce from the nearby farms and fruit and vegetable gardens are showcased on the menus. Tasting the local wines or craft beers you'll be spoilt for choice.

## DAY 2

### 7AM EARLY MORNING

For those that like some early morning activity – jump on a stand-up paddleboard (SUP) and literally walk on water! Savour the stillness of the morning, with the light streaming through the river red gums with a pale pink sky and the fresh clear morning air – you'll never want to leave! For those who would prefer an early morning walk or jog, the river setting provides for a great meditative experience – one you won't forget.

### 9 AM BREAKFAST

To cool off, sit in one of the outdoor cafes or indulge in one of the many quaint little cafes around town! A smoothie, a caffeine heart starter or tingling fresh water is a great way to refresh after the early morning activity.

### 10AM MID MORNING

Wander the Historic Port Precinct and High Street Shops. Visit the Echuca Historical Society for a history lesson of the river and local communities.

### 12 NOON LUNCH

Feed your appetite with a lunch at one of our many eating spots – Mediterranean, Vegan, Pub or Asian are all there for you to try.

### 2PM EARLY AFTERNOON

A short drive to the township of Kyabram 30 minutes away you'll find a quaint little Australian town where there is still a glimmer of yesteryear. Shop, visit the Kyabram Town Hall with its quality art and fashion exhibitions, don't miss the Kyabram Fauna Park with its up close and personal Australian animal experiences and drop into the camel farm for an interesting encounter with the camels.

### 4PM LATE AFTERNOON

To complete the day pop into the, flour mill or local pub – they all provide an insight into the unique way of Australian life.

### 7PM EVENING

In winter book dinner at one of the many local pubs with a roaring fire. In summer become part of the local scene and enjoy some of the balmy evenings in the beer gardens, clubs, pubs or music venues.





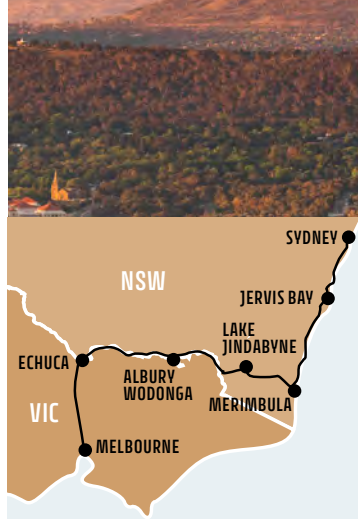
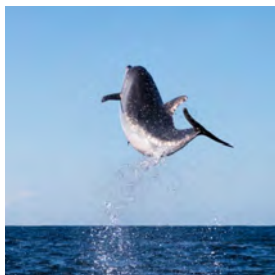

## SYDNEY TO MELBOURNE COAST & COUNTRY EXPLORER ROUTE – VIA ECHUCA

### HIGHLIGHTS

- Join a local Aboriginal guide for an insightful look into the lives of the local Yuin people.
- See kangaroos playing in the waves at Peppy Beach.
- Explore incredible exhibits at MAMA – Murray Arts Museum Albury.
- Indulge the taste buds on a food fossicking tour in Bendigo.

### DAY 1

Exchange urban views for the natural wonders of the coast as you begin the drive south to Melbourne via Echuca. The route takes you over the Sea Cliff Bridge which curves around the cliffs, floating 665 metres above the ocean waves. Arriving at Jervis Bay. Here, you'll find glorious white sandy beaches plus a mischievous pod of resident dolphins that play in the bay all year round.

### DAY 2

Take your time as you head onwards today. Ulladulla is only a short drive from Jervis Bay but packed with art galleries and treasured curio shops. Seafood lovers should check out the Oyster Shed on Wray Street as you pass through Bateman's Bay. Meandering ever southwards Bermagui is a pretty, coastal village famed for the crystalline blue waters that surround it and the famous Blue Rock Pool. From this charming spot continue to Merimbula.

### DAY 3

Today is a real road-trip. The route takes you deep into the legendary Snowy Mountains passing Lake Jindabyne and Mt Kosciuszko as you follow the Kosciuszko Alpine Way. Your destination is the twin cities of Albury Wodonga, straddling the Murray River.

### DAY 4

Today you're heading for Echuca Moama. Named after the Aboriginal word for 'meeting of the waters,' Echuca was once one of the busiest ports on the Murray River. Now, the twin towns of Echuca Moama are steeped in history. As you stroll along Murray Esplanade, where heritage buildings now house vibrant shops and cafes, the atmosphere of a bygone age is almost tangible. Time to board your PS Emmylou overnight cruise before ending your tour in Melbourne via Bendigo.

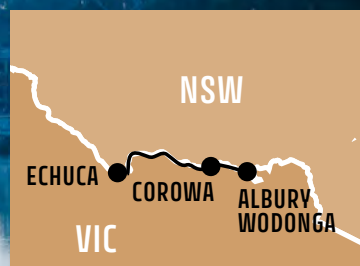

## ALBURY TO ECHUCA – MURRAY RIVER ROUTE

### HIGHLIGHTS

- Explore Murray Arts Museum Albury.
- Visit Corowa's Federation Museum & Whisky Factory
- Relax on Lake Mulwala or discover riverside walking tracks
- Indulge in the many gourmet food produced at Rich Glen Olive Estate.

### DAY 1

Head for Corowa following the Riverina Highway west through countryside patchworked with emerald farmland. Arrive in Corowa and discover a town that played a big role in federation, leading the charge to unite Australia's six colonies. The fascinating story is detailed at the Corowa Federation Museum, which also houses a collection of historic Aboriginal artefacts. Sample more of the region at Corowa Whisky and Chocolate, occupying 1920s flour mills now a on-site distillery producing a fiery single malt, plus port, sherry and bourbon, alongside handmade chocolate blocks and bars.

### DAY 2

Head to Yarrawonga-Mulwala. These twin cities occupying each bank of the Murray wraps up by



skirting man-made Lake Mulwala. This redgum-ringed reservoir boasts enormous populations of cod and crayfish. Explore walking trails, rent a kayak and soak up the serenity while bird-watching.

### DAY 3

The journey from Mulwala to Tocumwal hugs the river, passing the Big Reedy Lagoon Wildlife Reserve (a twitcher's paradise) along the way. Visit the historic Aerodrome Museum, which tells the story of Tocumwal's significance during WWII. The day's final 110km journey to Echuca is where you can board PS Emmylou for your overnight cruise departing from the Port of Echuca, once the third-largest port in Australia, behind only Sydney and Melbourne.



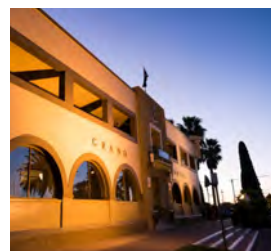

## ADELAIDE TO ECHUCA – FOLLOW THE MURRAY ROUTE

### HIGHLIGHTS

- Sip wine at quaint cellar doors in Victoria & South Australia
- Explore the largest open range Zoo in the world
- Cross in NSW from Mildura and explore NSW Perry Sandhills
- Step back in time with a visit to the Swan Hill Pioneer Settlement

### DAY 1

Head from Adelaide to Murray Bridge where your Murray River drive adventure really begins. Along the way enjoy the heritage town of Hahndorf in the Adelaide Hills known for its cool-climate wines and Australia's oldest surviving German settlement. Stop by the Murray Bridge Regional Gallery where you'll find contemporary craft and artworks.

### DAY 2

This morning visit the fabulous Monarto Safari Park, the largest open-range Zoo in the world. It is then time to check out Caudo Vineyard before heading to Renmark where you can relax and enjoy some outstanding food and wine from Banrock Station Wine and Wetland Centre.

### DAY 3

It is time to cross the border driving 1.5 hours to Mildura in Victoria, a town of rugged nature and

quiet charm. Cross the border into NSW to visit the Perry Sandhills perfect for a picnic and then finish the day at Red Cliffs Lookout where you will find auburn cliffs carved by the Murray River.

### DAY 4

Say goodbye to Mildura and set your sights on Swan Hill. It's about a 2.5 hour drive, but be sure to take your time as you weave alongside rivers and lakes. After you arrive in Swan Hill, explore the nearby Pioneer Settlement. Set on the banks of the Little Murray River, the Settlement tells the history of the Murray River with horse-drawn vehicles, blacksmiths, print shops.

### DAY 5

A short drive to Echuca where you can board PS Emmylou and experience the Port of Echuca precinct. In the 1870s, this was the third-largest port in Australia, behind only Sydney and Melbourne.



## ADELAIDE TO ECHUCA – INLAND GOURMET TRAIL

### HIGHLIGHTS

- Visit world heritage Naracoorte Caves and experience the underground world
- Savour the delights of the premier Coonawarra wine district
- Explore the Southern Grampians and dine at the renowned Royal Mail Hotel
- Delve into Australia Gold Rush history visiting Sovereign Hill, Ballarat
- Uncover Bendigo's fabulous Art and Food culture

### DAY 1

This morning rise early for the drive to Naracoorte in the limestone region of South Australia. Visit the Australian Fossil Mammal site, then visit the natural wonders of the Naracoorte Caves National Park with guided tours in the Alexandra and Victoria caves.

### DAY 2

Today visit the Coonawarra wine region, world-renowned for its Cabernet Sauvignon. See why it's called the Bordeaux of Australia, with 30 winery cellar doors. Visit historic Wynns Coonawarra Estate featuring the famous triple-gable roof and stone buildings, and Rymill Coonawarra with its full-sized bronze dancing horses, art and viewing gallery.

### DAY 3

Today we cross the border into Victoria visiting the beautiful city of Hamilton and the Hamilton Galley, before arriving in the Southern Grampians at Dunkeld. Visit the famous Royal Mail Hotel where

the mountains provide a stunning backdrop for a fine dining experience and overnight stay.

### DAY 4

Set your sights on Gold Country with a visit to Ballarat and Sovereign Hill, a recreated gold rush town and outdoor museum. Explore tunnels, shops, streetscapes and pan for real gold. If staying longer book an overnights stay at Craig's Royal Hotel. It's then time to visit Bendigo, the original gold rush boom town and home to the Centre Deborah Gold Mine. Explore its vibrant arts hub and world-class food and wine scene, set against rich gold-rush history, grand architecture and magnificent gardens.

### DAY 5

A short drive to Echuca where you can board PS Emmylou and experience the Port of Echuca precinct. In the 1870s, this was the third-largest port in Australia, behind only Sydney and Melbourne.



# ECHUCA MOAMA

## Silo Art Trail

### SMALL TOWNS & SURROUNDS



It's big, it's bold, it's beautiful, and it's no wonder that the popularity of silo art has boomed across Australia over the past six years.

The Echuca Moama region and surrounds is home to three spectacular art silos and one art water tank. Follow the map in this brochure and explore our other art and cultural attractions along the way.

#### ROCHESTER

The Rochester GrainCorp Silos were the first silos painted in the Echuca Moama region and are the work of artist, Jimmy Dvate. Completed in 2018, the silos feature two threatened local species, the azure king fisher and the wrist-winged squirrel glider.  
18 Ramsay St, Rochester

#### Nearby:

- **Iddles Lane:** Former Victoria Police homicide detective, Ron Iddles, has been commemorated in his hometown of Rochester. The Iddles Lane mural was painted by Tim Bowtell and celebrates the achievements of one of the state's most respected detectives.
- **Mural Park:** Located off Moore Street in Rochester, Mural Park features a selection of 2.1m x 4.8m murals created as part of the annual Rochester Mural Festival. New murals are added each year.

- **Rochester Sports Museum:** View more than 4,000 exhibits showcasing Australia's sporting history, including Adam Gilchrist's wicket-keeping gloves, one of Greg Norman's iconic hats, and a tennis dress worn by Martina Navratilova.

#### COLBINABBIN

The six-silo art mural in Colbinabbin was painted by Tim Bowtell in 2020, and depicts significant moments from the town's history, including its important links to agriculture, community, environment and the construction of the railway.  
Collins St, Colbinabbin

#### KYABRAM WATER TANK

The Kyabram water tank, owned by Goulburn Valley Water, is the most recent addition to the Echuca Moama region's silo art. Painted by Jimmy Dvate in March 2021, it features the Kyabram Fauna Park wetlands and some of the wildlife that inhabit them, including the eastern long neck turtle, golden whistler, red-capped robin, yellow crimson rosella, Major-Mitchell's cockatoo, endangered plains-wanderer, spotted-tail quoll, blue skimmer dragonfly, brolga and a bush tone-curlew.  
Cnr Drum & Union St, Kyabram

#### Nearby:

- **Kyabram Town Hall Gallery:** Housed in the historic town hall building, the gallery is one of the largest in the region and showcases regional artists, touring exhibitions and a changing exhibition program of vintage clothing.
- **Tongala:** Visit Tongala and marvel at the 40+ street murals painted on buildings and fences around the town centre. The Hay Bale Trail also pops up at Christmas and Easter, with local artists and farmers coming together to add even more colour to this artistic town. 15 mins drive from Kyabram.

- **Stanhope:** Visit dedicated country music venue, the Neon Horse; the Many Makers Gallery; Shaque-a-Taque with its miniature villages and handcrafted gifts; and the Fonterra Mural, which features thousands of individual photos that create one enchanting artwork. 15 mins drive from Kyabram
- **Girgarre Sound Walk:** A hands-on musical journey through town, using repurposed materials to create interactive musical instruments. 15 mins drive from Kyabram, 8 mins drive from Stanhope.

#### PICOLA

Around 45 minutes drive from Echuca Moama is the Picola art silo, which was painted by Jimmy Dvate in 2020. It features the culturally significant Barmah National Park and some of the wildlife that calls it home. The silos are still operational and located on private land, however can be viewed from the roadside.  
25 Moran St, Picola

#### ECHUCA MOAMA

While staying in Echuca Moama, be sure to visit some of the local art experiences on offer.

- **Galleries:** Customs House Gallery, Foundry Arts Space, Whistlestop Gallery; Port Atelier & Alton Gallery
- **Museums:** Port of Echuca Discovery Centre, Echuca Historical Society Museum, National Holden Museum, Chanter Estate Military Museum, and The Great Aussie Beer Shed and Heritage Farm Museum
- **Outdoor art:** David Maughan's Les Belle Helen II sculpture in the Moama Botanic Gardens, Geoff Hocking's Long Paddock sculptures near the Moama Soundshell and Timber Cutters sculptures at Edward River Bridge picnic area, Corey Thomas's Long Paddock sculptures at the Mathoura Visitor Information Centre, and Jimmy Dvate's mural on the side wall of the Gunbower Hotel.



# Trail map



Visit [echucamoama.com](http://echucamoama.com) to see more art experiences from around the region and the Campaspe Arts Trail map.

Suggested Route

\*MAP NOT TO SCALE

*Echuca Moama*  
The Murray's living legend

To get firsthand local information and to book your Echuca Moama experience visit the **Echuca Moama Visitor Centre**. Free call **1800 804 446**, visit the website **[www.echucamoama.com](http://www.echucamoama.com)** or find us right on the river, just before the bridge at 2 Heygarth Street, Echuca.





# Terms & Conditions

## General

The transportation of guests and baggage aboard the vessel/s is governed by these Terms and Conditions. Please carefully read the terms of this cruise agreement.

Your payment of deposit or full fare constitutes agreement to these terms and conditions which includes limitations and exonerations of the liabilities and obligations of Carrier. You should read and understand these terms and conditions carefully before making a deposit. The vessel/s is operated by Australian Paddlesteamers Pty Ltd, trading as Murray River Paddlesteamers (MRPS) and is regularly inspected by the Australian Maritime Safety Authority, AMSA.

## Definitions

The terms "you" and "Guests" refer to any and all person(s) named on the front of the Confirmation and include all children or others under the care or control of the named person(s). The term "Carrier" includes Murray River Paddlesteamers, its parent and affiliated entities, the vessels, the owners, charterers, operators, agents, and masters and crews thereof, any substituted or connecting ship, the owners, charterers and operators and all launches belonging to any such boat or owned or operated by the owners, charterers or operators. The term "Fare" includes voyage and shore excursions purchased from Carrier.

**Fares are in Australian Dollars, are per guest, are based on double occupancy, and do not include air or land transport.** Single Occupancy Fares carry a 60% surcharge. Port charges are included in the fare. All fares, itineraries, themes, entertainment, shore excursions and other voyage attributes are subject to change without notice and we reserve the right to not honour any published prices that we determine were erroneous due to printing, electronic or clerical error.

## Deposit and Final Payment

For confirmation of individual bookings, a non refundable deposit of \$400 of the full fare per person is due upon booking online & within 3 days if booking direct or via a travel agent. The balance of the voyage fare is due ninety days (90) prior to departure date, and all reservations not fully paid at such time will be cancelled and subject to the cancellation provisions set forth in the cancellation policy below. MRPS accepts the following forms of payment: MasterCard, Visa & Bank Transfer. A credit card surcharge between 1.20% - 1.70% maybe incurred for credit card payments depending on the credit card used. Domestic Australian Bank Transfers incur no surcharge or cost. International Bank Transfers incur a minimum A\$15 fee which must be added to the payment made. Bookings made ninety (90) days or less prior to the departure date require payment in full at the time of booking.

## Cancellation and Change Policy

Guests who must cancel or change the date of their voyage or any part of their package for any reason, including medical or family reasons, are subject to the fees as outlined below. All fares are based on double occupancy; on reservations in which one guest cancels, the remaining guest is responsible for paying any and all single supplements. MRPS reserves the right to cancel all reservations for which final payment is not received ninety (90) days prior to the departure date.

You acknowledge that your cancellation will cause MRPS difficulty in selling a replacement cruise and thus the cancellation fees herein apply regardless of whether your cruise is resold. You agree that any losses sustained by MRPS in the event of cancellation would be very difficult or impossible to quantify and the cancellation fees are fair and reasonable as liquidated damages. The following cancellation fees will be assessed for all written cancellations received prior to departure up to the scheduled time of departure. Any approved booking changes will incur a administration fee of A\$150 per change.

## Days Prior to Departure

Up to 91 days	Loss of Deposit
90-61 days	50% of gross fare
60-0 days	100% of gross fare

## Insurance

You acknowledge that you will hold suitable travel insurance which covers your cruise.

## Included in your fare

- Bottled water/softdrink
- All meals • Coffee & Tea
- Selected Wine & Beer with dinner
- All standard shore excursions
- Wi-Fi Internet access aboard the vessel
- Gratuities to vessel crew

## Not included in your fare

- Airfare to and from your home city
- Alcoholic beverages not stated
- Travel Insurance
- Transfers to and from Melbourne

Payment for additional goods and services must be made prior to the guest's disembarkation. Card only payment. No cash is accepted.

## Documentation

Final travel reminder, including itinerary and passenger cruise information guide will be sent 30 days prior to departure. Itineraries are subject to change without notice.

## Health & Disability Requirements

Guests must notify MRPS in writing at the time of booking of any physical or mental illness, disability or other conditions for which special accommodations or the use of a wheelchair is necessary or contemplated. Also, we must be notified of any medical treatment that may render the guest unfit for travel or constitute a risk or danger to the guest or anyone else aboard. The vessel does not carry a medical doctor aboard. Acute medical conditions will require you to disembark to be attended to by shore-side emergency and/or medical response. Guests needing any form of assistance and those who are physically disabled must be accompanied by someone who will take full responsibility for any needed assistance during the cruise and in the event of an emergency. We reserve the right to refuse passage to anyone who, in our sole opinion, may affect the health, safety or enjoyment of other guests. Guests requiring a wheelchair must provide their own collapsible wheelchair. Please be aware that some ports of call, shore excursions, docks, gangways and other requirements may preclude a wheelchair guest from leaving the vessel; this decision will be made by the ship's captain and is binding. Also, there may be certain physical conditions, including stairways and narrow passageways within the vessel that may limit or preclude the accessibility of wheelchair guests to some areas. You acknowledge that you hold suitable travel insurance which covers your cruise.

## COVID-19 Health

Before booking and before you travel, ensure you check the latest government travel requirements and our website which will also include onboard protocols. Guests must comply with the captains instructions regarding all COVID-19 hygiene and social distancing requirements.

## Contracting COVID-19 prior to your cruise

The week before your cruise we recommend guests self isolate and avoid high-risk settings where possible. If you cannot cruise due to contracting COVID-19 a future cruise credit or refund will not be offered. You acknowledge that you hold comprehensive travel insurance that includes coverage for this event.

## Smoking

Smoking is not permitted anywhere aboard the vessel including inside cabins and suites.

## Dining Arrangements

MRPS offers open-seating for breakfast, lunch and dinner. To make a seating request with other guests aboard please contact us.

## Gambling

Gambling is not permitted on the Vessel/s.

## Animals

Only designated service animals are permitted aboard. You are required to notify MRPS in advance of departure if you plan to bring along a service animal because of a disability. Supporting documents may be requested.

## Carrier's Discretion

As the Carrier, we reserve the right at any time, without notice, to cancel any cruise or Cruise Tour, to change or postpone the date or time of sailing or arrival, to change the port of embarkation or final destination, to shorten the cruise or to change or substitute any component of the Cruise Tour.

If we are required to do any of these things, we will be responsible to you as follows:

If we cancel the cruise or Cruise Tour before it has started, we will refund the Cruise Fare that we have actually received. If the scheduled sailing date or time is delayed and as a result of that delay, you are not otherwise accommodated on board the Ship, we may arrange hotel accommodations and food at no additional expense to you for the duration of the delay. If the cruise is shortened, we will make a proportionate refund of the Cruise Fare. MRP responsibility does not extend beyond the vessel, and whenever passengers leave it, any arrangements made by them or for them are at their own risk.

## Limitation on Carrier's Liability

- (a) No liability for certain events. The Carrier and the vessel/s shall not be liable for loss, death, or delay of, or injury to, any passenger or loss or damage or delay to his/her baggage, personal effects or other property, arising from: acts of God ie Floods, public enemy, government restraint to operate, riots, strikes, lockouts, labour troubles, whoever may be the instigators thereof, epidemic, civil disturbances of whatever nature, perils of the rivers, or other navigable waters, fuel shortages, collision, stranding, fire, theft, barratry, or any other crime by any person, faults or errors of navigation or management of this or any other vessel, explosions, breakage of shafts or any defect or unseaworthiness in hull, machinery or appurtenances, equipment, furnishings or supplies of the vessel or launches or vehicles or any defect of the Carrier's premises, at whatever time existing, fault or neglect of pilots, tugs, regular members of the crew, agents, servants, independent contractors.
- (b) Limitation on Carrier's liability with respect to baggage and personal property. This liability shall not exceed one hundred Australian Dollars in the event of loss, damage or delay to any of the passenger's baggage or other property taken with him/her on the voyage.

## Guest Warranties.

You warrant that you and all other Guests traveling with you are physically, emotionally and otherwise fit to undertake the cruise or Cruise Tour; that you and they have received all medical inoculations necessary; that you and they will at all times comply with the Ship's rules and regulations and orders and directions of the Ship's Captain and officers, and that your conduct will not impair the safety of the Ship or jeopardize or inconvenience other Guests. We may disembark at any time any Guest who may be suffering from contagious or infectious diseases or whose presence, in the opinion of the Captain, may be detrimental to the comfort or safety of other Guests or the crew. In such cases, the Guest shall not be entitled to any refund of the cruise fare or Cruise Tour fare or any compensation whatsoever.

## Alcohol Policy

The sale and consumption of alcoholic beverages will be limited to Guests who are 18 years or older. MRPS promotes the responsible service of alcohol and will refuse service to guests if deemed to be intoxicated. Guests are kindly reminded to consume alcohol in moderation. MRPS reserves the right to prohibit and retain all liquor brought onto vessels which is strictly prohibited.

## Use of Likeness

Carrier has the exclusive right to use video and other visual/ audio portrayals of you or your likeness taken during your cruise in any medium of any nature whatsoever for any purpose, including advertising or promoting the services of Carrier without any compensation being paid to You. Any such portrayal or likeness shall be the exclusive property of the Carrier.

## Children

Due to the nature of the cruise and travel itineraries, the Carrier does not maintain facilities or services on its vessels for individuals under the age of 18 years. You must be 18 years old on or before the day you are scheduled to embark on the cruise tour.

## Non-Transferrable Tickets

- (a) Your authority to agree. In buying the passenger ticket you state that you are authorised by or on behalf of any passenger listed on the ticket (including any minor) to agree to all the terms and conditions of this agreement.
- (b) No transfer. This agreement is between the Carrier and the passenger. It cannot be sold, assigned or transferred to any other person without prior express written consent of the Carrier. MRPS reserves the right to approve amendments to bookings which will incur a \$150 administration fee per change.

Terms and conditions are subject to change without notice and we are not responsible for errors or omissions therein.





# CRUISE Traveller

AUSTRALIA'S MOST EXPERIENCED SMALL SHIP CRUISE SPECIALIST

For enquiries please contact Cruise Traveller:

Phone: 1800 507 777  
[sales@cruisetraveller.com.au](mailto:sales@cruisetraveller.com.au)  
[www.cruisetraveller.com.au](http://www.cruisetraveller.com.au)